

SPECIFICATION & DETAILS

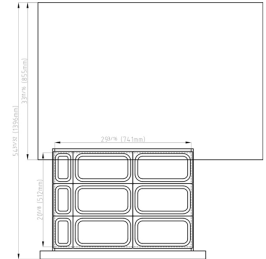

© PFCBR/L-48D2

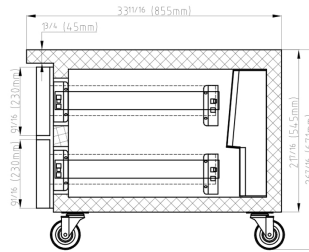
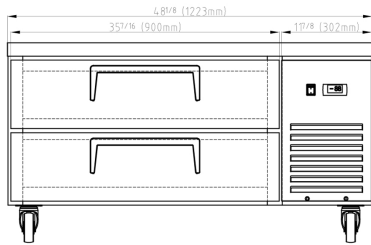
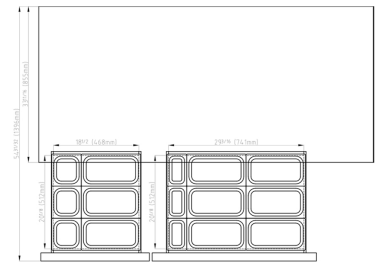
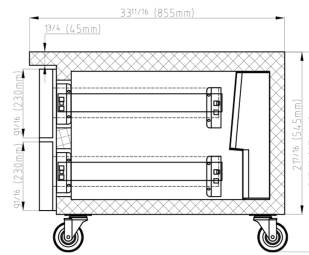
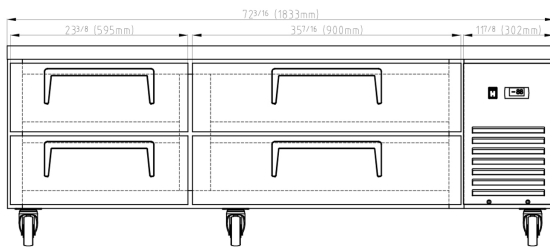

© PFCBR/L-72D4

Model No.	Net Capacity	Unit Dimensions W x D X H	Packaging Dimensions W x D X H	Voltage Frequency	Temp. Range	Refrigerant	40'HC QTY
PFCBR/L-36D2	5.5 Cu.Ft	36 1/8" x 33 11/16" x 26 7/16"	38 3/8" x 36 7/16" x 29 9/16"	115V / 60Hz	- 8°F ~ -2°F	R290	97
PFCBR/L-48D2	9.0 Cu.Ft	48 1/8" x 33 11/16" x 26 7/16"	50 3/8" x 36 7/16" x 29 9/16"	115V / 60Hz	- 8°F ~ -2°F	R290	72
PFCBR/L-60D2	12.4 Cu.Ft	60 1/8" x 33 11/16" x 26 7/16"	62 13/16" x 36 7/16" x 29 9/16"	115V / 60Hz	- 8°F ~ -2°F	R290	58
PFCBR/L-72D4	17.7 Cu.Ft	72 3/16" x 33 11/16" x 26 7/16"	74 13/16" x 36 7/16" x 29 9/16"	115V / 60Hz	- 8°F ~ -2°F	R290	48
PFCBR/L-84D4	18.9 Cu.Ft	84 3/16" x 33 11/16" x 26 7/16"	86 13/16" x 36 7/16" x 29 9/16"	115V / 60Hz	- 8°F ~ -2°F	R290	42
PFCBR/L-96D4	22.3 Cu.Ft	96 3/16" x 33 11/16" x 26 7/16"	98 13/16" x 36 7/16" x 29 9/16"	115V / 60Hz	- 8°F ~ -2°F	R290	37

© NOTE: SINOWER RESERVES THE RIGHT TO CHANGE SPECIFICATIONS WITHOUT NOTICE