

## SPECIFICATION & DETAILS

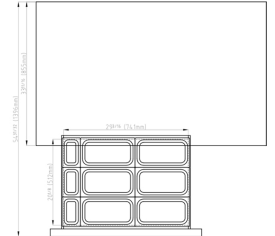

© PRCBR/L-48D2-E

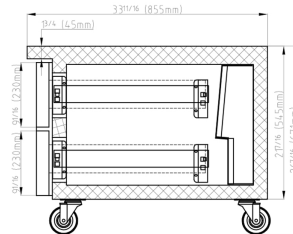
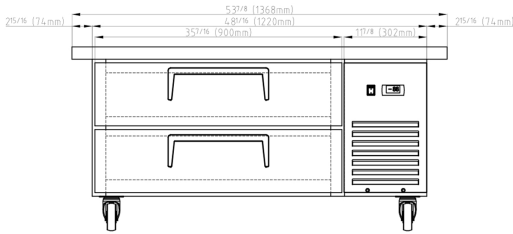
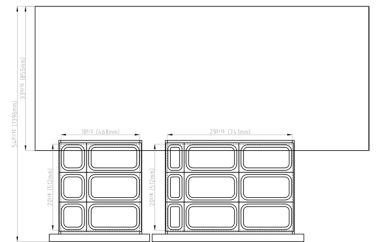
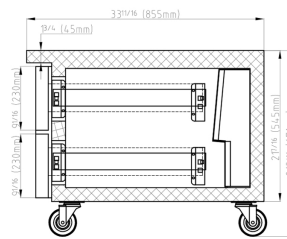
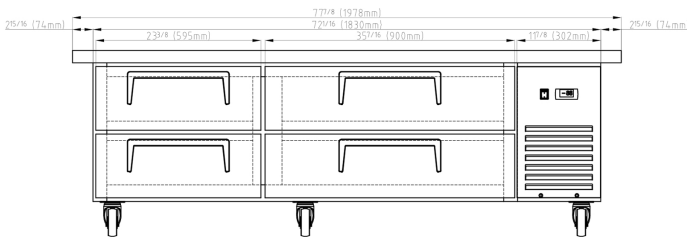

© PRCBR/L-72D4-E

Model No.	Net Capacity	Unit Dimensions W x D X H	Packaging Dimensions W x D X H	Voltage Frequency	Temp. Range	Refrigerant	40'HC QTY
PRCBR/L-36D2-E	5.5 Cu.Ft	41 7/8" x 33 1/16" x26 7/16"	44 5/8" x 36 7/16" x 29 9/16"	115V / 60Hz	33°F ~ 39°F	R290	83
PRCBR/L-48D2-E	9.0 Cu.Ft	53 7/8" x 33 1/16" x26 7/16"	57 5/8" x 36 7/16" x 29 9/16"	115V / 60Hz	33°F ~ 39°F	R290	64
PRCBR/L-60D2-E	12.4 Cu.Ft	65 7/8" x 33 11/16" x26 7/16"	68 5/8" x 36 7/16" x 29 9/16"	115V / 60Hz	33°F ~ 39°F	R290	54
PRCBR/L-72D4-E	17.7 Cu.Ft	77 7/8" x 33 11/16" x26 7/16"	80 5/8" x 36 7/16" x 29 9/16"	115V / 60Hz	33°F ~ 39°F	R290	46
PRCBR/L-84D4-E	18.9 Cu.Ft	89 7/8" x 33 11/16" x26 7/16"	92 5/8" x 36 7/16" x 29 9/16"	115V / 60Hz	33°F ~ 39°F	R290	40
PRCBR/L-96D4-E	22.3 Cu.Ft	101 7/8" x 33 11/16" x26 7/16"	104 5/8" x 36 7/16" x 29 9/16"	115V / 60Hz	33°F ~ 39°F	R290	35

© NOTE: SINOWER RESERVES THE RIGHT TO CHANGE SPECIFICATIONS WITHOUT NOTICE